

COME MIDNIGHT

MAY 16 - JUNE 21, 2015

OPENING RECEPTION: MAY 15, 11:59PM - MAY 16, 8AM

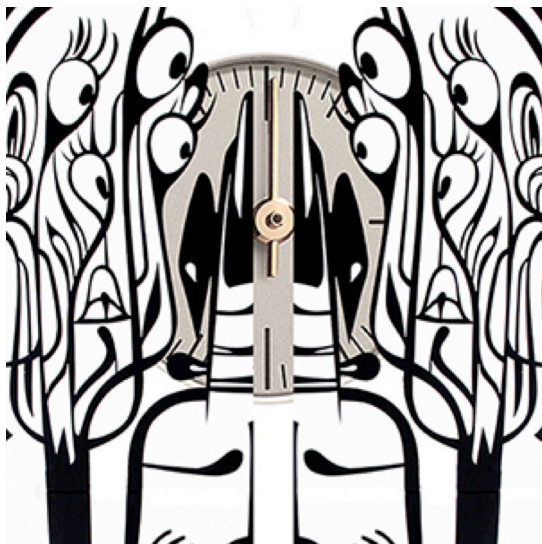

Richard Taittinger Gallery presents ***Come Midnight***, a solo exhibition of new work by Turkish artist **Haluk Akakçe**. In his first US presentation in nearly a decade, Akakçe uses the notion of transformation as a key to investigate the delicate balance between the earth and spirit world. The visionary exhibition showcases all new works: video, paintings, and drawings. Keeping in the theme of the exhibition, the opening reception will take place on the morning of **May 16**, from midnight to 8am. Entitled after the “zero hour” of transition between one day and the next, *Come Midnight* embraces the fleeting, intangible, ephemeral aspects of life and aligns these with the physical world.

Akakçe challenges society’s reliance on logic and rationality. In response, the artist choreographs forms in relentless flux. His technique of freehandedly shaping subjects captures the tenuous moment when the corporal and ethereal worlds collide, when decisions made by the psyche translate into physical motion.

The front gallery space represents the “physical world” with large-scale paintings and works on paper. The viewer then navigates through a

transitional soundscape pathway, created in collaboration with composer Michael Vecchio, which culminates in the “spirit world.” The back gallery is illuminated by *Moonlight Serenade* (2015), a single channel video installation that expresses nostalgia for a romantic past and highlights the possibility of organic sensitivity amidst cold mechanization.

The viewer is offered a momentary, fragile, and sensitive vision of transitional states akin to the flutter of butterfly wings. *Come Midnight* will remain on view through June 21.

ABOUT HALUK AKAKÇE

Haluk Akakçe (b. 1970) inquires into the existence of alternate time and space on two- and three-dimensional surfaces as well as in moving imagery. Akakçe’s unique practice stems from his early training as an Interior Architect and Environmental Designer in Ankara, Turkey. He earned his MFA from the School of the Art Institute of Chicago. The first time Akakçe presented his work was at the Drawing Center in 1998, while his first video piece *The Measure of All Things* was shown at MoMA PS1 in 2000. In 2001, he was commissioned by the Whitney Museum of American Art and exhibited at Phillip Morris. In 2005, his *Birth of Art* was selected for the prestigious British Art Show and featured on the cover of the exhibition catalogue. Akakçe’s work is included in several major international collections: MAXXI, Rome; Fondation Louis Vuitton, Paris; Istanbul Modern Art Museum, Istanbul; Hoffman Collection, Berlin; and Thyssen-Bornemisza Art Contemporary, Vienna.

FOR PRESS INQUIRIES

Andrea Walsh
Nadine Johnson & Associates
andrea@nadinejohnson.com
T +1 (212) 228-5555

RICHARD
TAITTINGER
GALLERY

T +1 (212) 634-7154
F +1 (212) 634-7155
info@richardtaittinger.com

154 Ludlow Street
New York, NY 10002
www.richardtaittinger.com

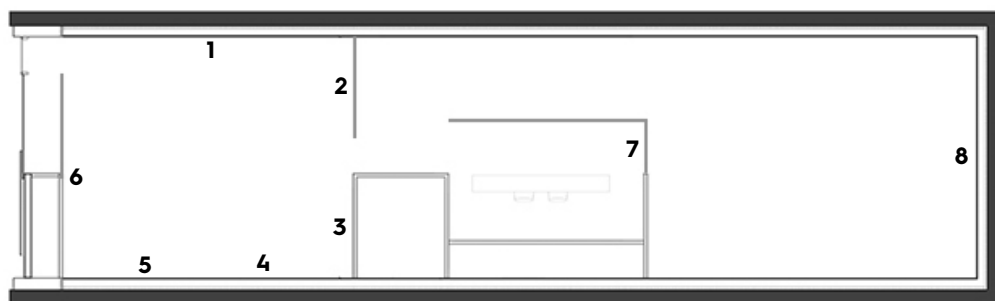

1
Sunshine on her shoulders, 2015
 Acrylic on wood panel, 82 x 101 in.

2
The Awakening, 2015
 Acrylic on wood panel, 78 x 80 in.

3
Transformation of the survival, 2015
 Acrylic on wood panel, 78 x 80 in.

4
Something that meant something to me at some point, 2015
 Acrylic on wood panel, 78 x 80 in.

5
I will wait for you even if it takes a million years, 2015
 Acrylic on wood panel, 78 x 80 in.

6
Celebration of the return of life, 2015
 Drawing installation
 Acrylic on processed museum board
 40 x 32 in. (unframed); 43 x 35.5 in. (framed)
 (from left to right, top to bottom)

The Career Girl, 2015
The Mother, 2015
The Pianist, 2015
The Lover, 2015
The Architect, 2015
The Psychotherapist, 2015
The Tailor, 2015
The Dancer, 2015
The Aviator, 2015

7
The Storyteller, 2015
 Acrylic on processed museum board
 40 x 32 in. (unframed); 43 x 35.5 in. (framed)

8
Moonlight Serenade, 2015
 Single channel video projection, color with sound
 3 min 20 sec

ABOUT RICHARD TAITTINGER GALLERY

An international forum for new ideas in contemporary art, Richard Taittinger Gallery presents an ambitious program dedicated to cultivating a critical dialogue between artists, viewers and institutions. Embracing its prime location in the Lower East Side, the gallery provides a foundation that supports the presentation of work by mid-career artists with significant global recognition.

**RICHARD
 TAITTINGER
 GALLERY**

T +1 (212) 634-7154
 F +1 (212) 634-7155
info@richardtaittinger.com

154 Ludlow Street
 New York, NY 10002
www.richardtaittinger.com